

46 Universal Motor

Application

- Home Appliances
- Coffee Maker With Grinder

Motor Characteristics

- Diameter: 46mm
- Length: 96mm
- Shaft Diameter: 6.35mm
- Weight: 360g
- Nominal Voltage: 120V~
- Frequency: 50/60Hz

Standard Data

- Operation Temperature: -10~55°C
- Storage Temperature: -20~100°C
- Mounting: Any Position
- Electrical Connection: Lead Wire
- Winding Temperature (Tmax): 130°C
- Direction of Rotation: CW

Dimensions

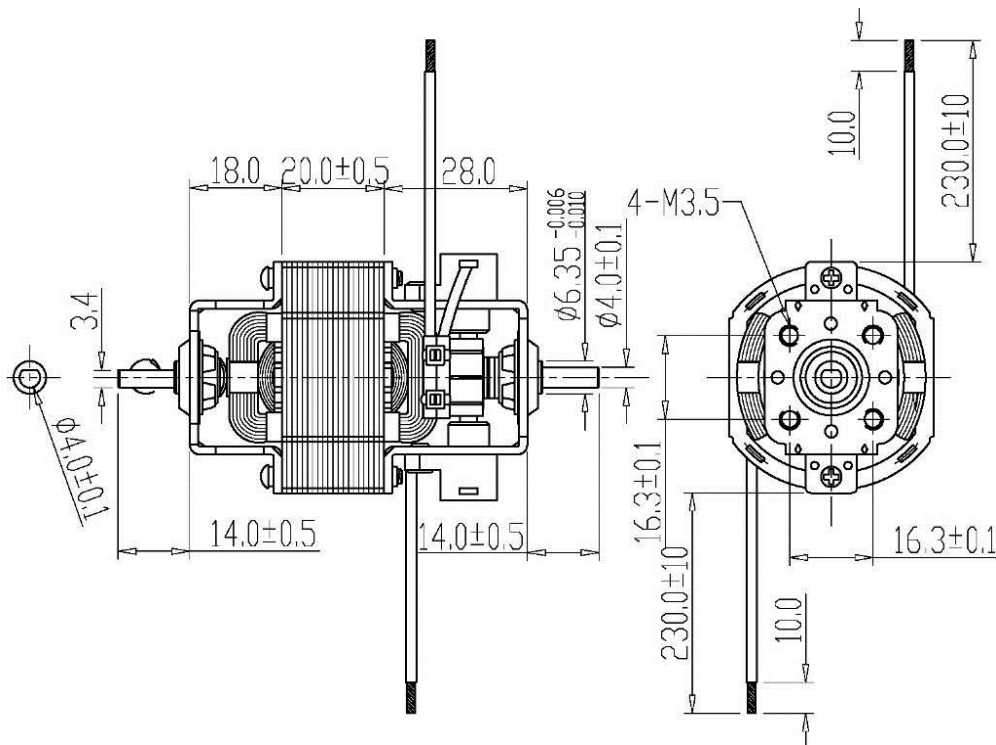
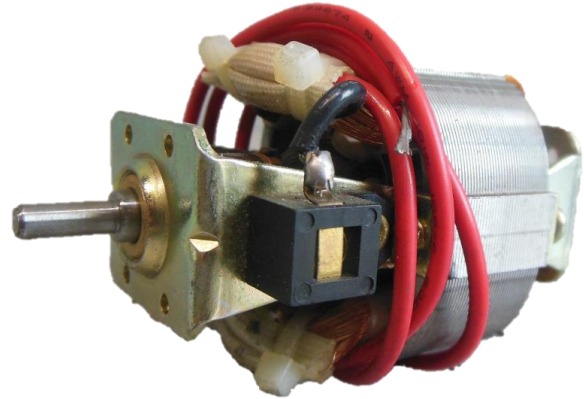

【Above dimensions & below data are for your ref only. For detailed info or customized requirements, you are very welcome to inquire.】

Model No.	Rated Voltage [V]	No-Load Speed [r/min]	No-Load Current [A]	Rated Torque [mNm]	Rated Speed [R.P.M.]	Rated Current [A]
4620	AC 120V	24600	0.58	7.6	20000	0.8
Model No.	Torque Constant [g-cm/A]	Max-Efficiency [%]	Out-Pout [Watt]	Number of Pole/Pair	Dimensions [mm]	Weight [g]
4620		46	73	2	54	356

Characteristic curve :

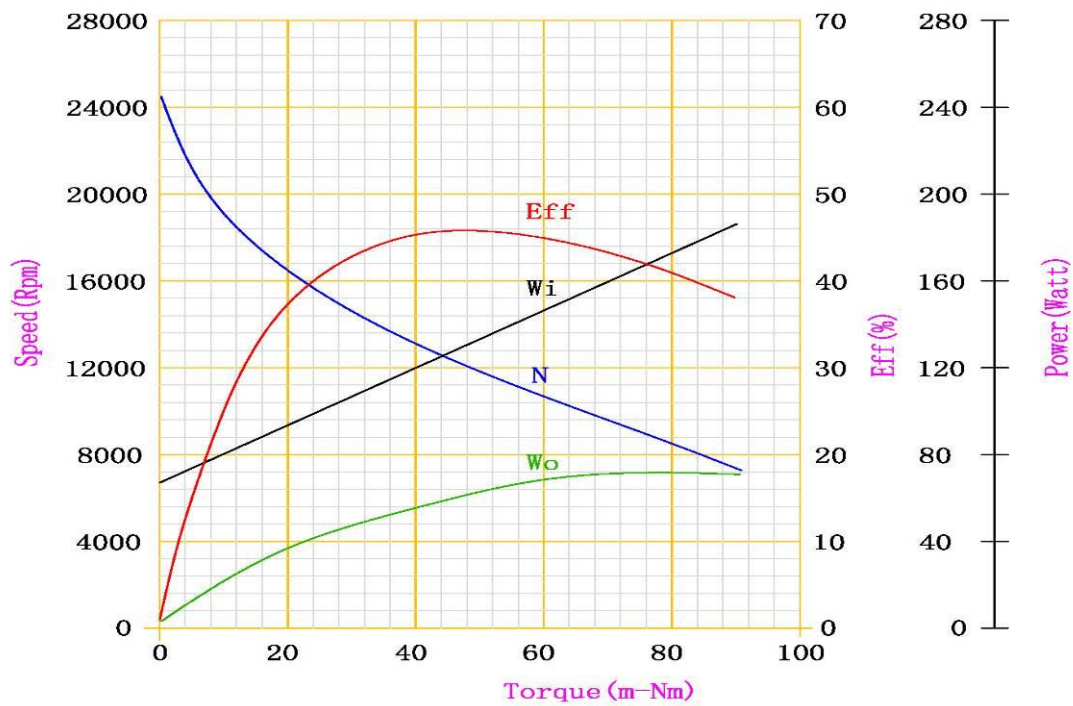

54 Universal Motor

Application

- Home Appliances
- Coffee Maker With Grinder

Motor Characteristics

- Diameter: 54mm
- Length: 96mm
- Shaft Diameter: 6.35mm
- Weight: 360g
- Nominal Voltage: 120V~
- Frequency: 50/60Hz

Standard Data

- Operation Temperature: -10~55°C
- Storage Temperature: -20~100°C
- Mounting: Any Position
- Electrical Connection: Lead Wire
- Winding Temperature (Tmax): 130°C
- Direction of Rotation: CCW

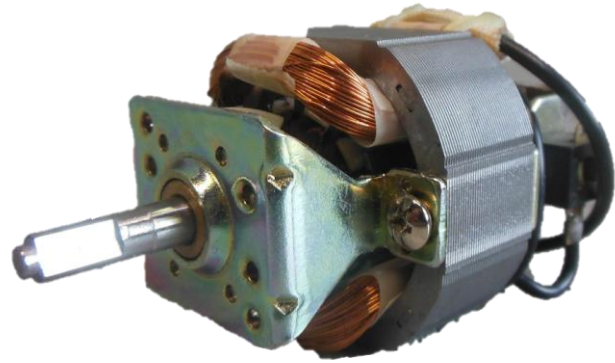

Dimensions

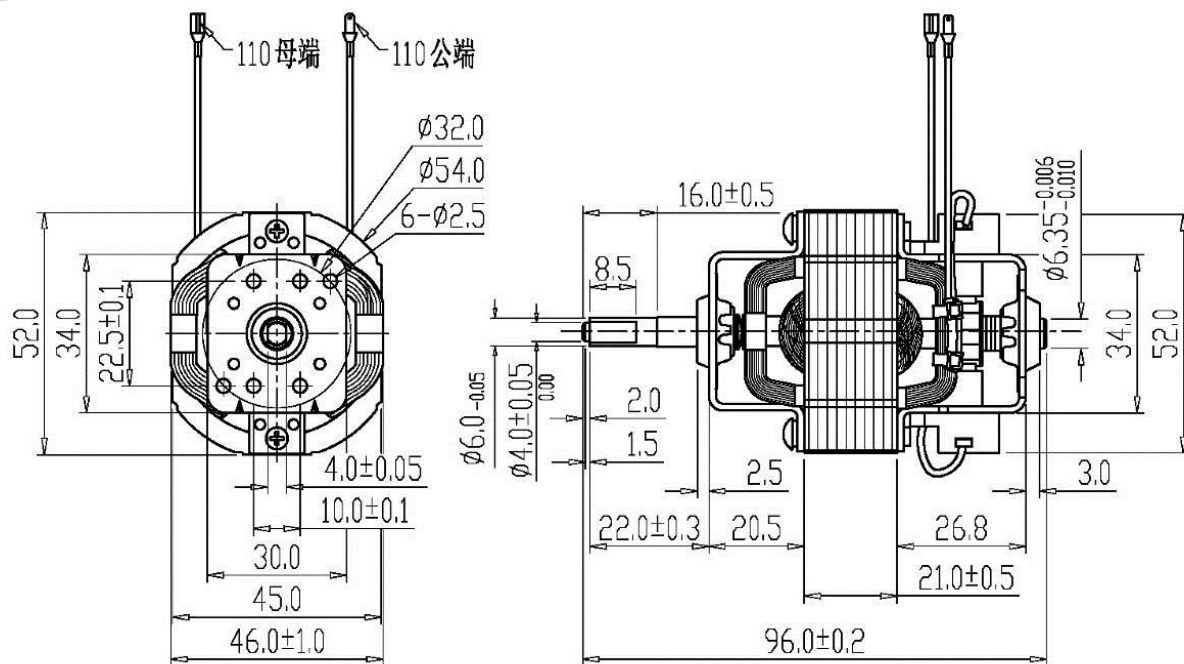

【Above dimensions & below data are for your ref only. For detailed info or customized requirements, you are very welcome to inquire.】

Model No.	Rated Voltage [V]	No-Load Speed [r/min]	No-Load Current [A]	Rated Torque [mNm]	Rated Speed [R.P.M.]	Rated Current [A]
5421	AC 120V	24600	0.58	7.6	20000	0.8
Model No.	Torque Constant [g-cm/A]	Max-Efficiency [%]	Out-Pout [Watt]	Number of Pole/Pair	Dimensions [mm]	Weight [g]
5421		46	73	2	54	356

Characteristic curve :

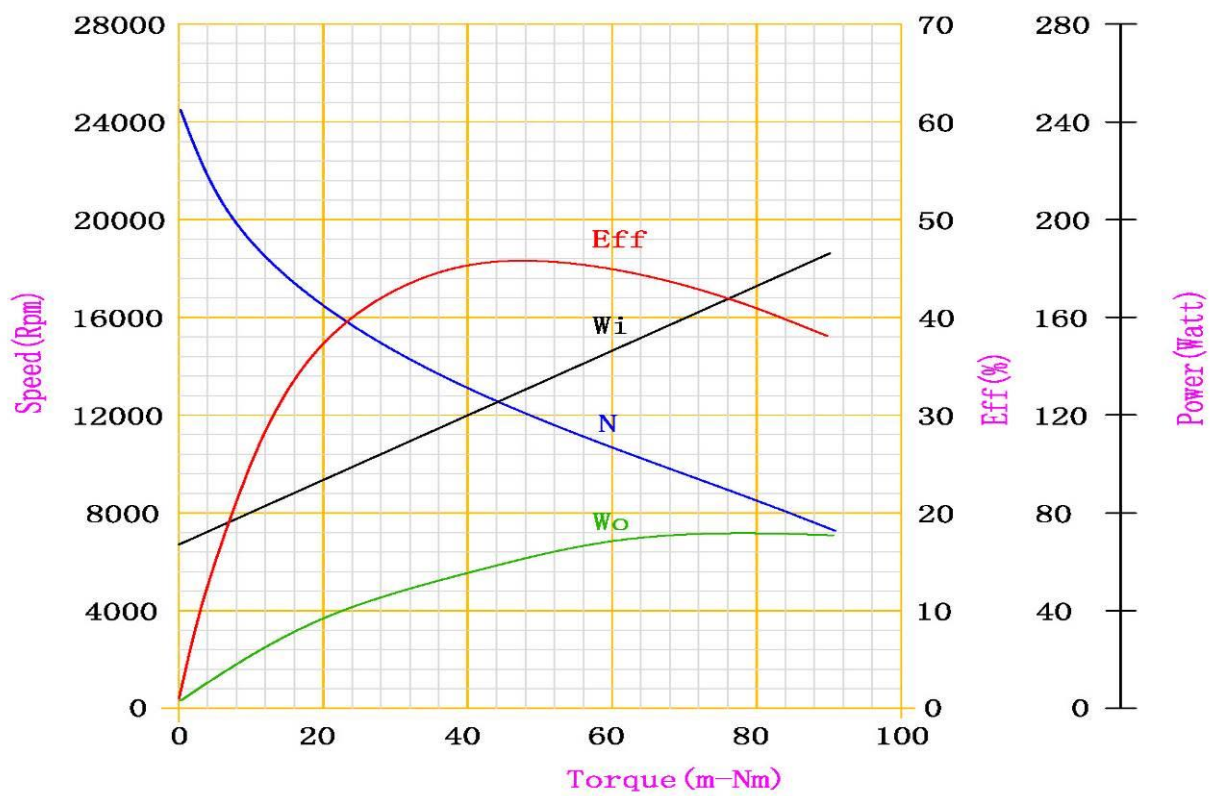

54 Universal Motor

Application

- Home Appliances
- Blender/ Food Processor

Motor Characteristics

- Diameter: 54mm
- Length: 131.6mm
- Shaft Diameter: 6.35mm
- Weight: 610g
- Nominal Voltage: 127V~
- Frequency: 50/60Hz

Standard Data

- Operation Temperature:-10~55°C
- Storage Temperature:-20~100°C
- Mounting: Any Position
- Electrical Connection: Lead Wire
- Winding Temperature (Tmax): 1.55°C
- Direction of Rotation: CW

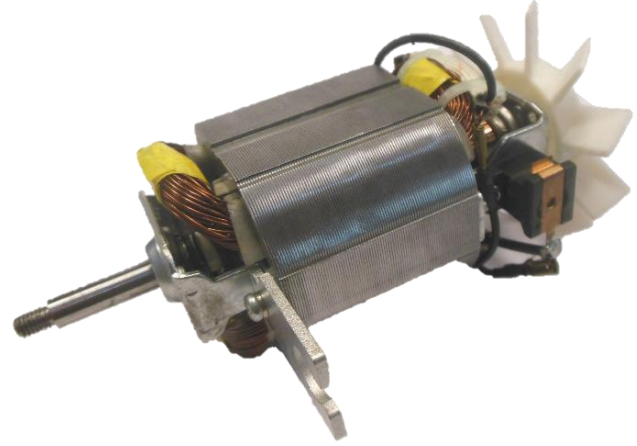

Dimensions

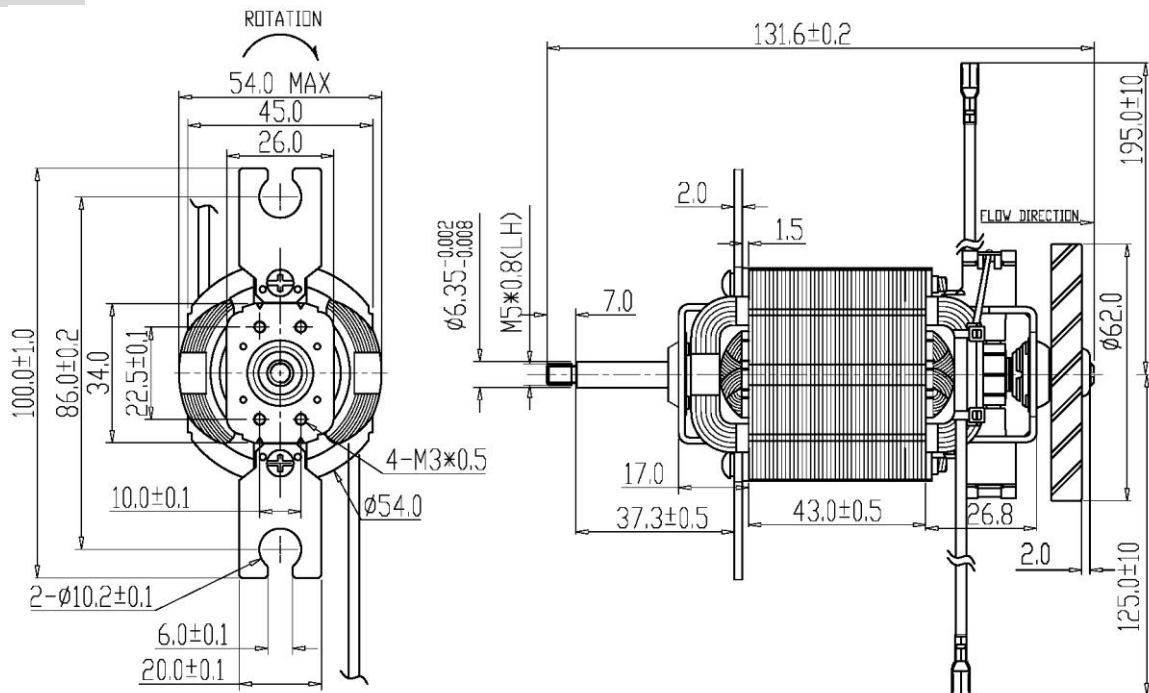

【Above dimensions & below data are for your ref only. For detailed info or customized requirements, you are very welcome to inquire.】

Model No.	Rated Voltage [V]	No-Load Speed [r/min]	No-Load Current [A]	Rated Torque [mNm]	Rated Speed [R.P.M.]	Rated Current [A]
5443	AC 127V	24600	0.58	7.6	20000	0.8
Model No.	Torque Constant [g-cm/A]	Max-Efficiency [%]	Out-Pout [Watt]	Number of Pole/Pair	Dimensions [mm]	Weight [g]
5443		46	73	2	54	356

Characteristic curve :

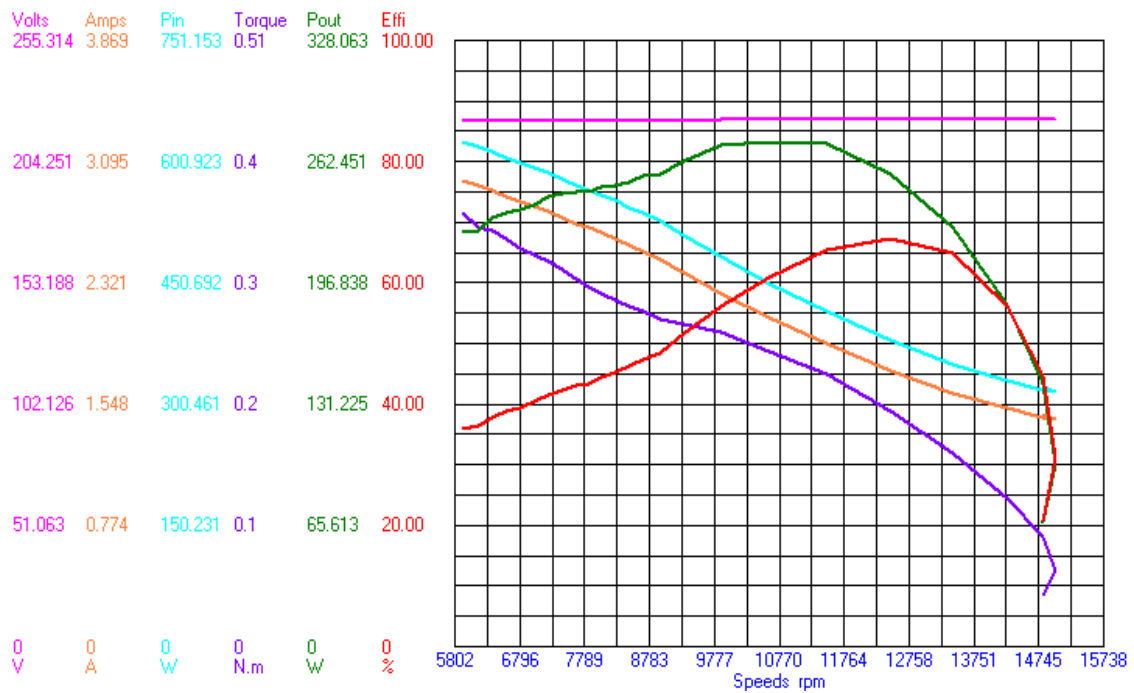

55 Universal Motor (Handmixer Motor)

Application

- Home Appliances
- Hand-held Mixer

Motor Characteristics

- Diameter: 55mm
- Length: 142mm
- Shaft Diameter: 7.14mm
- Weight: 528g
- Nominal Voltage: 220V~
- Frequency: 50Hz

Standard Data

- Operation Temperature: -10~55°C
- Storage Temperature: -20~100°C
- Mounting: Any Position
- Electrical Connection: Terminal
- Winding Temperature (Tmax): 130°C
- Direction of Rotation: CW

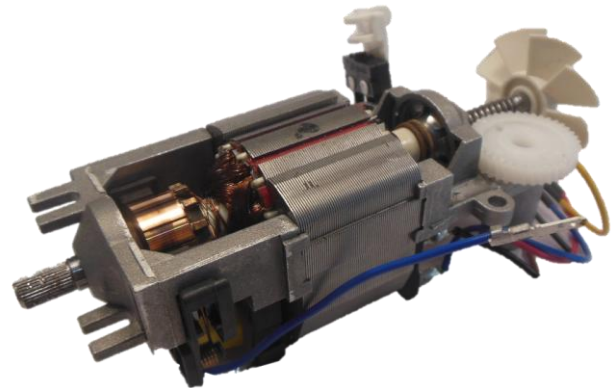

Dimensions

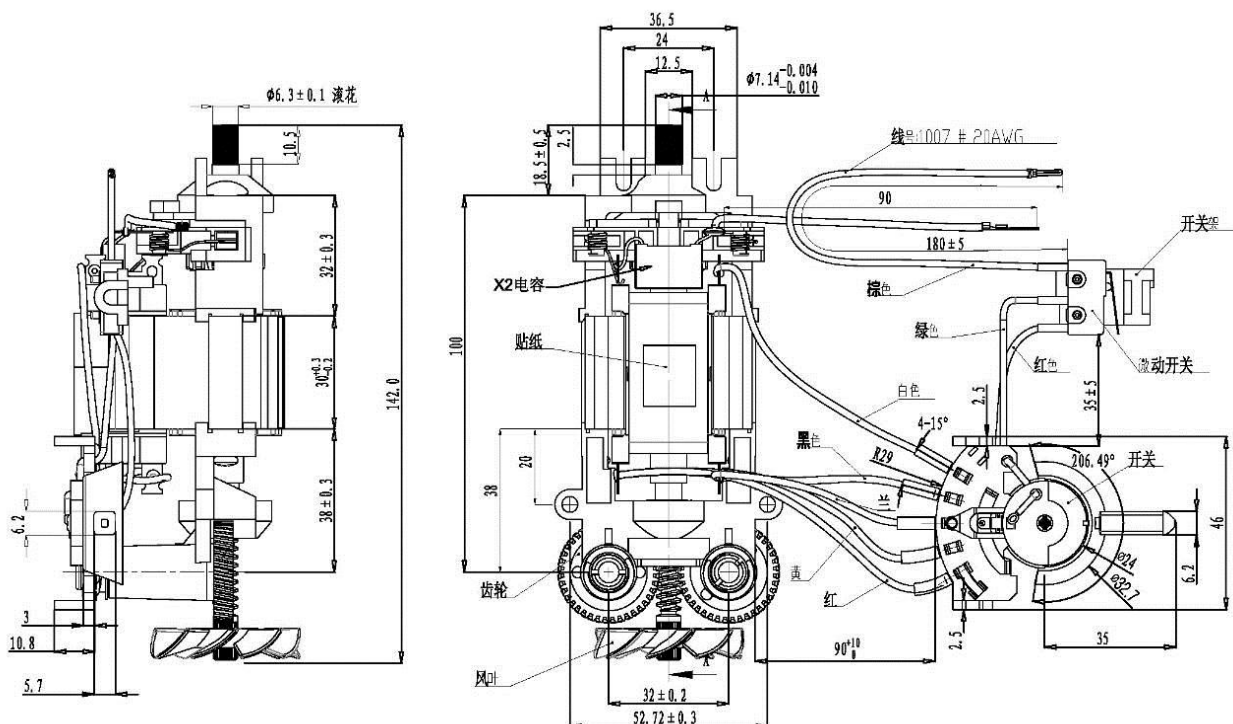

【Above dimensions & below data are for your ref only. For detailed info or customized requirements, you are very welcome to inquire.】

Model No.	Rated Voltage [V]	No-Load Speed [r/min]	No-Load Current [A]	Rated Torque [N.m]	Rated Speed [R.P.M.]	Rated Current [A]
5530	AC 220V	25000	0.7	0.3	20000	1.1
Model No.	Torque Constant [g-cm/A]	Max-Efficiency [%]	Out-Pout [Watt]	Number of Pole/Pair	Dimensions [mm]	Weight [g]
5530		42	80	1	55	528

Characteristic curve :

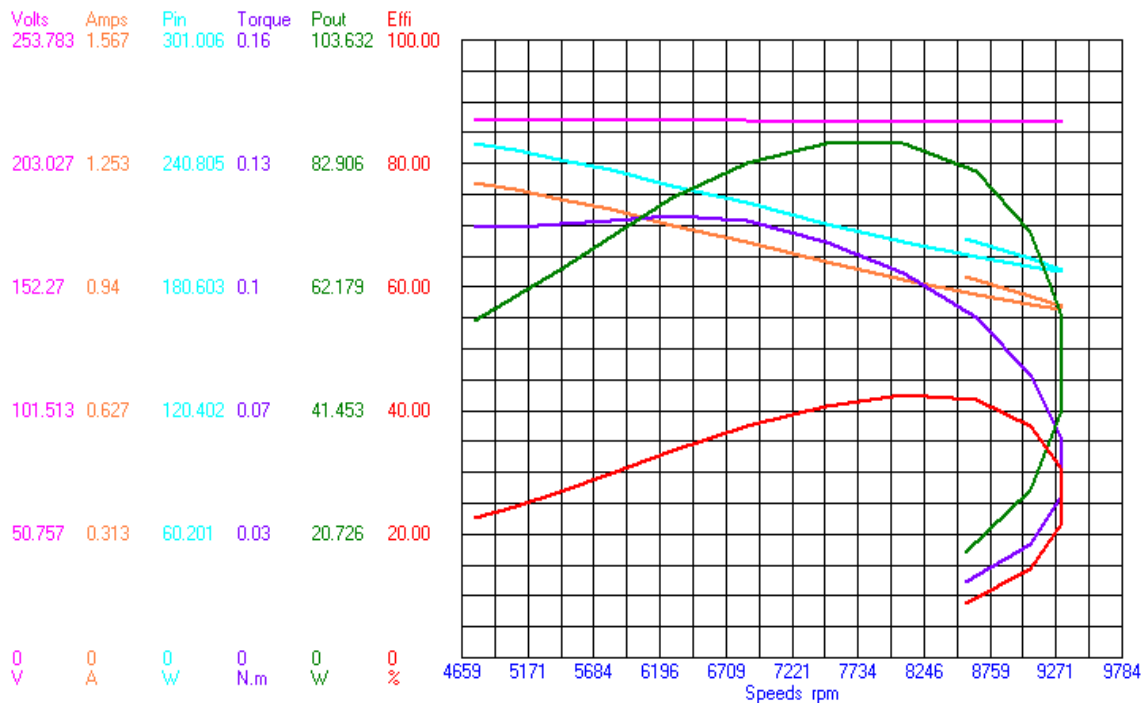

70 Universal Motor

Application

- Home Appliances
- Meat Mincer

Motor Characteristics

- Diameter: 70mm
- Length: 145mm
- Shaft Diameter: 8mm
- Weight: 900g
- Nominal Voltage: 230V~
- Frequency: 50Hz

Standard Data

- Operation Temperature: -10~55°C
- Storage Temperature: -20~100°C
- Mounting: Any Position
- Electrical Connection: Lead Wire
- Winding Temperature (Tmax): 130°C
- Direction of Rotation: C.CW

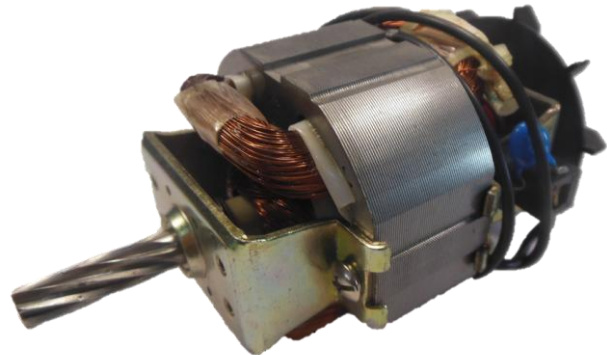

Dimensions

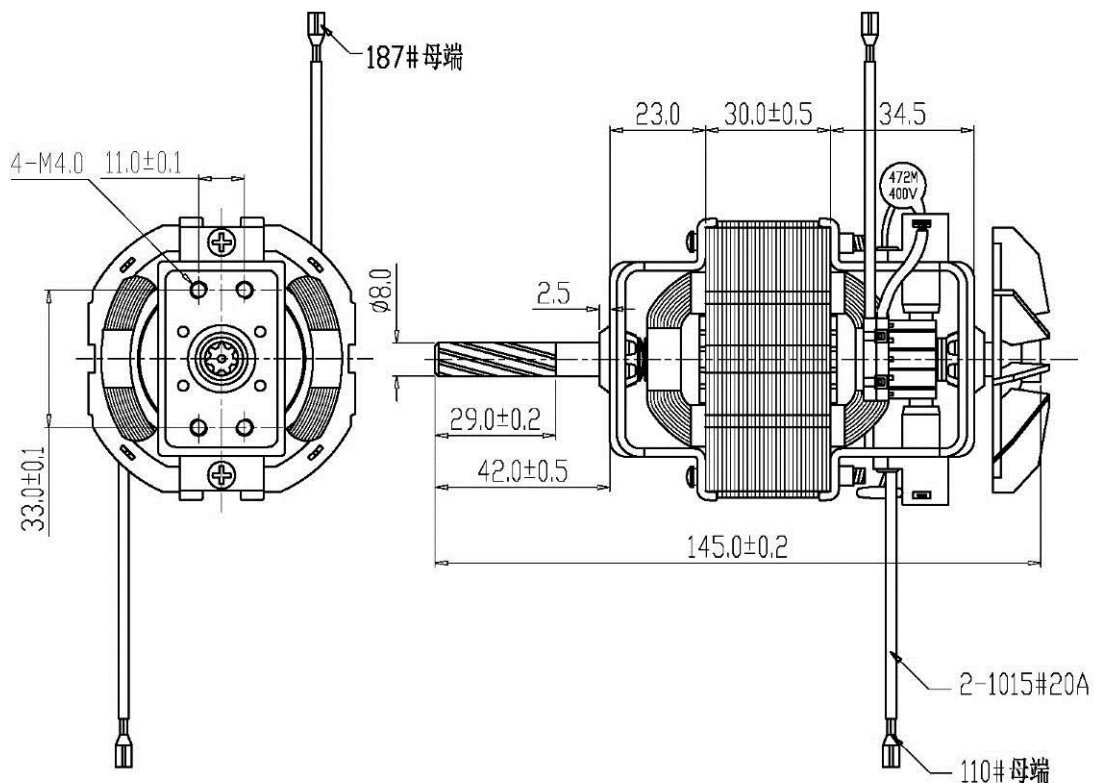

【Above dimensions & below data are for your ref only. For detailed info or customized requirements, you are very welcome to inquire.】

Model No.	Rated Voltage [V]	No-Load Speed [r/min]	No-Load Current [A]	Rated Torque [Kg-cm]	Rated Speed [R.P.M.]	Rated Current [A]
7030	AC 230V	18440	0.606	2.13	10825	1.54
Model No.	In Pout [Watt]	Max-Efficiency [%]	Out-Pout [Watt]	Number of Pole/Pair	Dimensions [mm]	Weight [g]
7030	331	71	233	2	70	900

Characteristic curve :

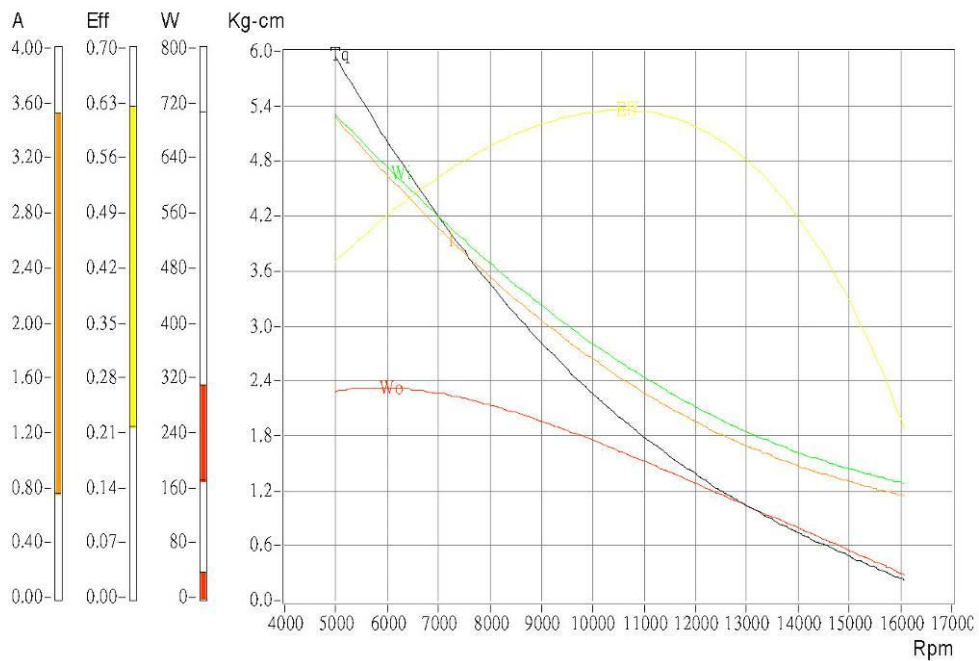

76 Universal Motor

Application

- Home Appliances
- Blender/ Food Processor

Motor Characteristics

- Diameter: 76mm
- Length: 115mm
- Shaft Diameter: 8mm
- Weight: 713g
- Nominal Voltage: 120V~
- Frequency: 60Hz

Standard Data

- Operation Temperature: -10~55°C
- Storage Temperature: -20~100°C
- Mounting: Any Position
- Electrical Connection: Terminal
- Winding Temperature (Tmax): 130°C
- Direction of Rotation: CW

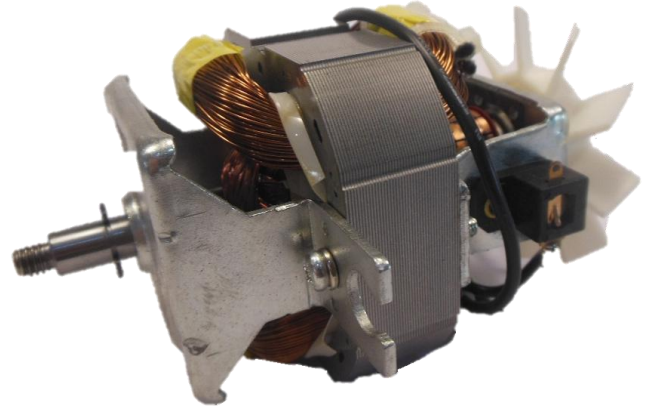

Dimensions

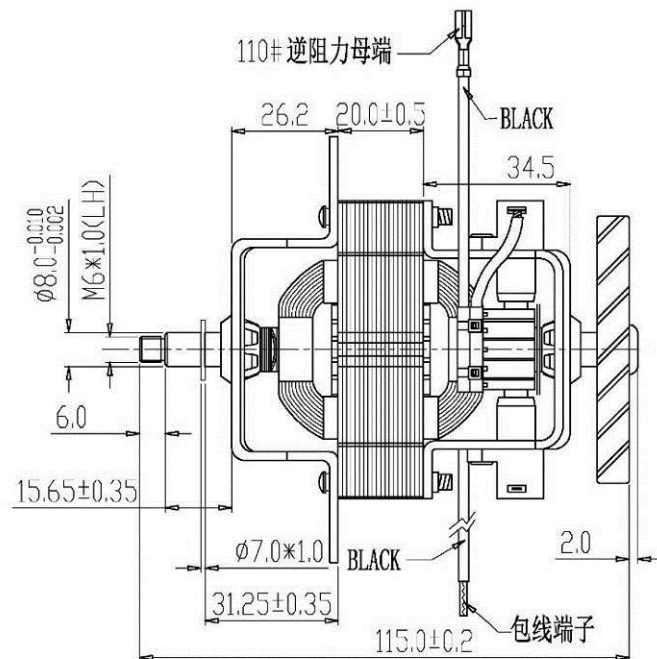
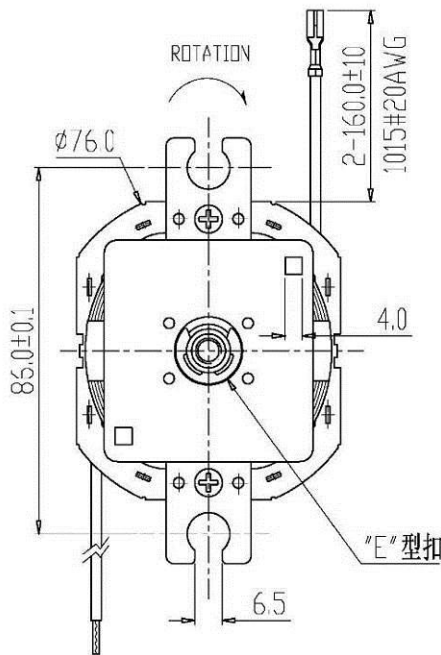

【Above dimensions & below data are for your ref only. For detailed info or customized requirements, you are very welcome to inquire.】

Model No.	Rated Voltage [V]	No-Load Speed [r/min]	No-Load Current [A]	Rated Torque [Kg-cm]	Rated Speed [R.P.M.]	Rated Current [A]
7620	AC 120V	20410	1.54	1.6	11650	3.2
Model No.	In Pout [Watt]	Max-Efficiency [%]	Out-Pout [Watt]	Number of Pole/Pair	Dimensions [mm]	Weight [g]
7620	360	52	190	2	76	713

Characteristic curve :

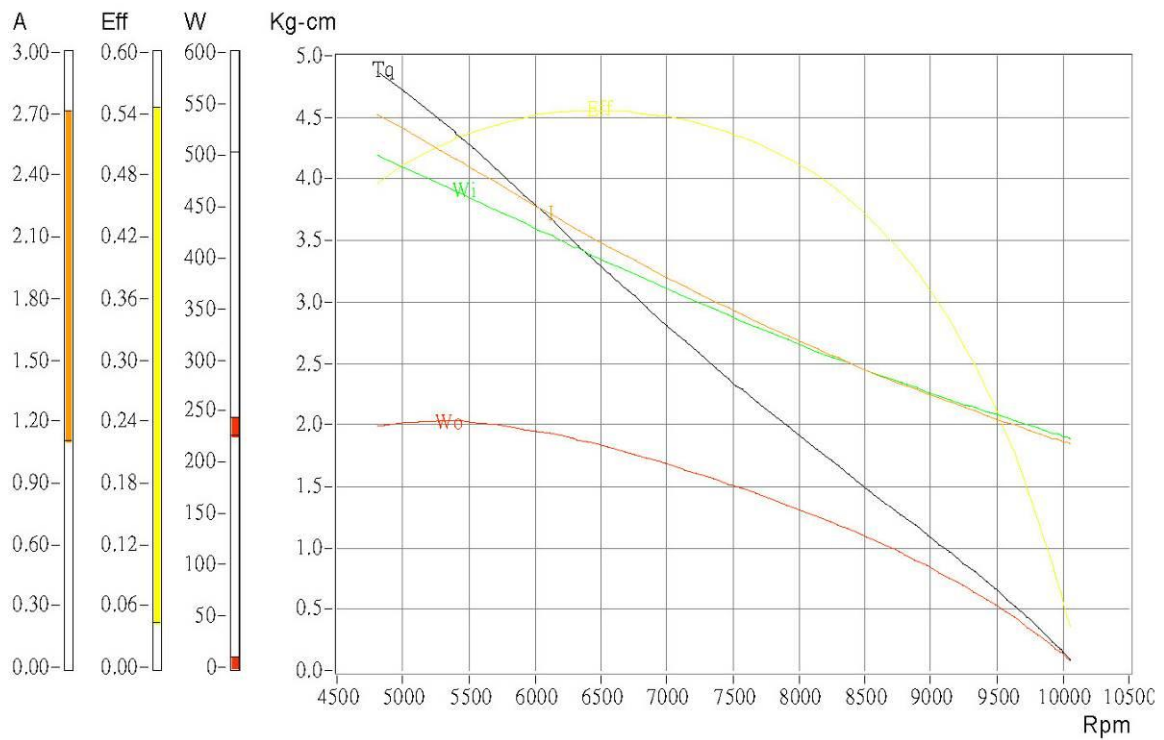

76 Universal Motor

Application

- Home Appliances
- Blender/ Food Processor/ Meat Mincer

Motor Characteristics

- Diameter: 76mm
- Length: 146.5mm
- Shaft Diameter: 8mm
- Weight: 955g
- Nominal Voltage: 230V~
- Frequency: 50Hz

Standard Data

- Operation Temperature: -10~55°C
- Storage Temperature: -20~100°C
- Mounting: Any Position
- Electrical Connection: Terminal
- Winding Temperature (Tmax): 130°C
- Direction of Rotation: C.CW/CW

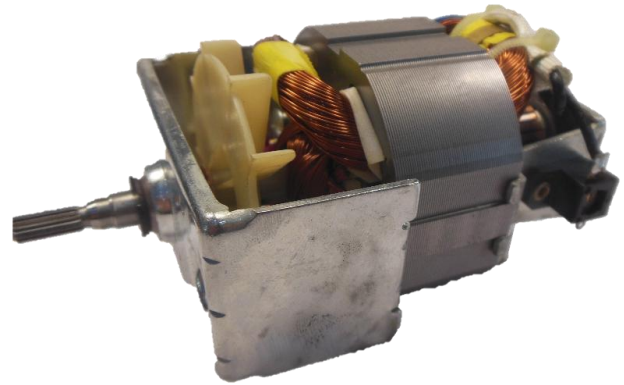

Dimensions

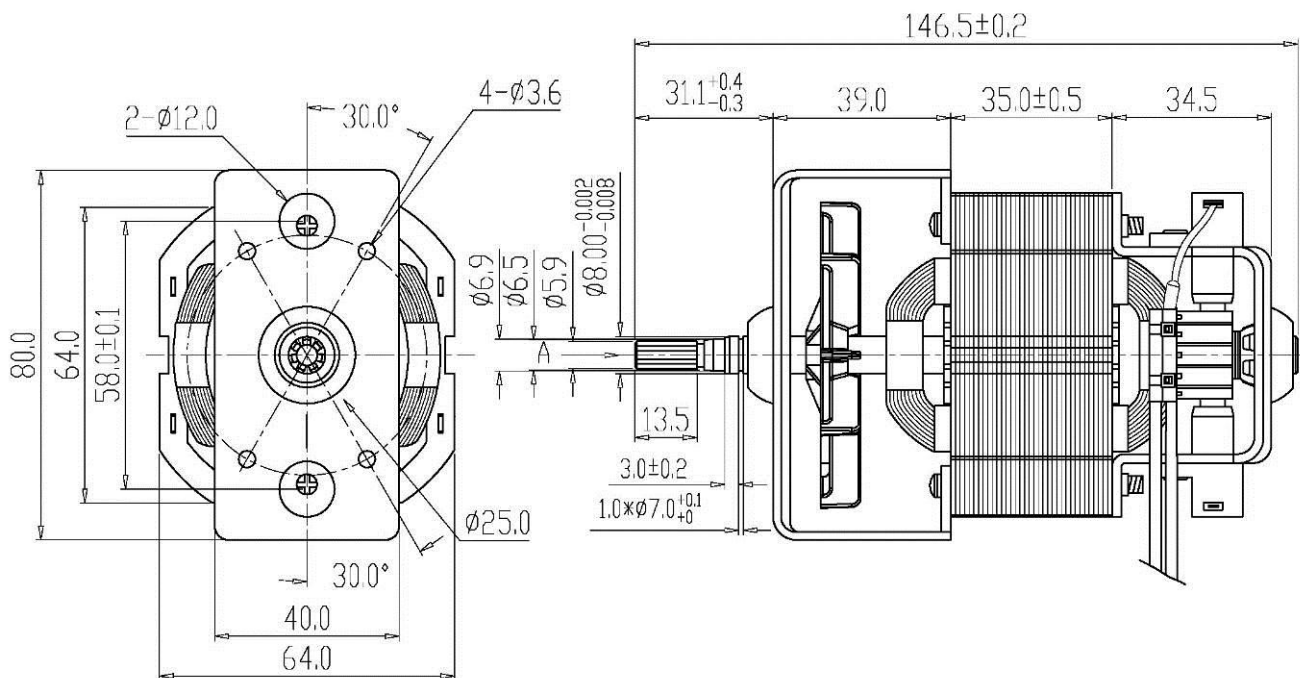

【Above dimensions & below data are for your ref only. For detailed info or customized requirements, you are very welcome to inquire.】

Model No.	Rated Voltage [V]	No-Load Speed [r/min]	No-Load Current [A]	Rated Torque [Kg-cm]	Rated Speed [R.P.M.]	Rated Current [A]
7635	AC 230V	14537	0.62	3.2	6571	2.0
Model No.	In Pout [Watt]	Max-Efficiency [%]	Out-Pout [Watt]	Number of Pole/Pair	Dimensions [mm]	Weight [g]
7635	396	56	221	2	76	955

Characteristic curve :

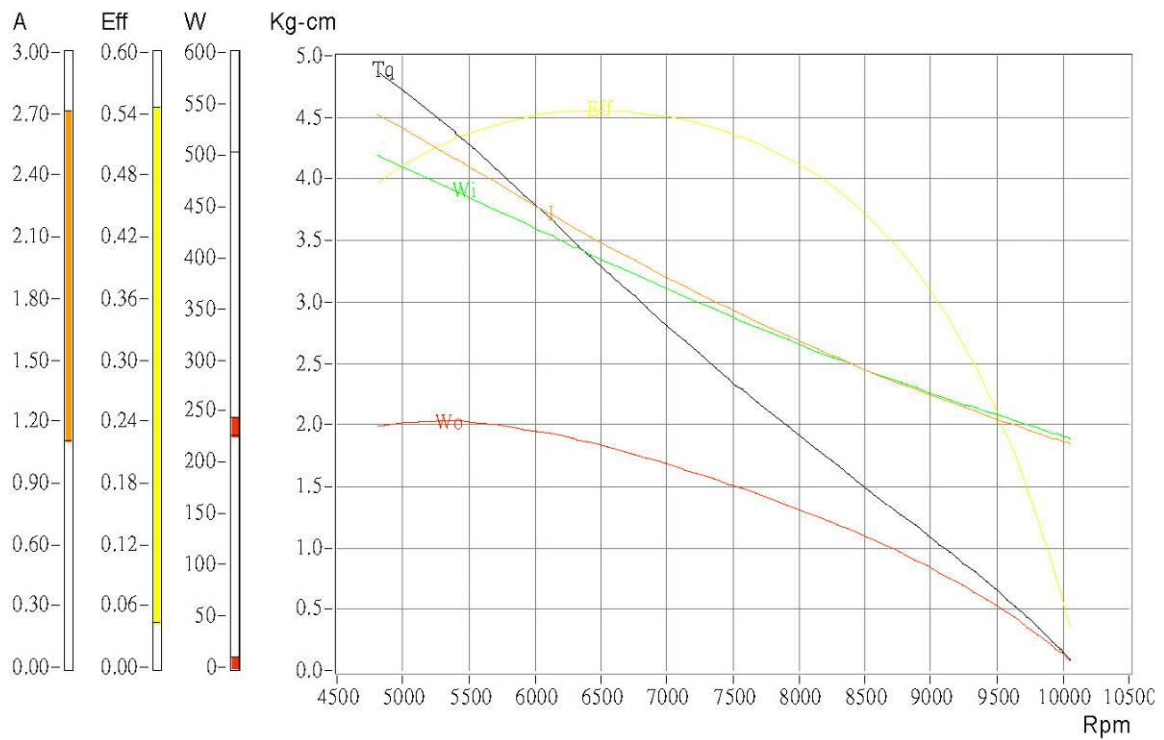

82 Universal Motor (Vacuum Cleaner Motor)

Application

- Floor Care
- Vacuum Cleaner/ Hand Dryer (Air Towel)

Motor Characteristics

- Diameter: 129mm
- Shaft Diameter: 8mm
- Weight: 1298g
- Nominal Voltage: 120V~
- Frequency: 60Hz

Standard Data

- Operation Temperature: -10~55°C
- Storage Temperature: -20~100°C
- Mounting: Any Position
- Electrical Connection: Leadwire/ plus terminal
- Winding Temperature (Tmax): 130°C
- Direction of Rotation: CW
- Standard: UL Component Recognition
CSA Construction Certification



Dimensions

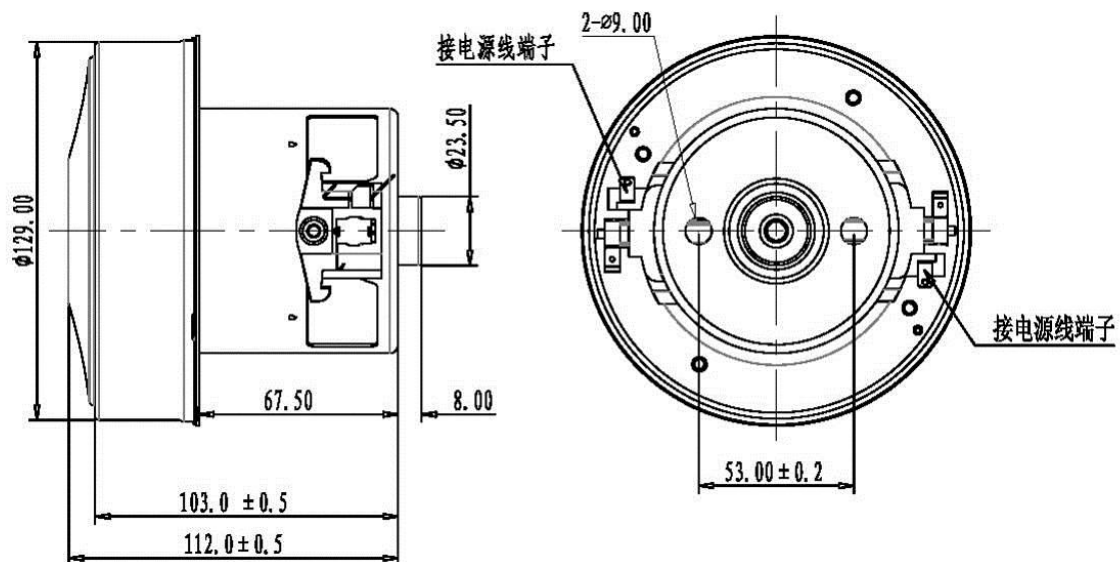

【Above dimensions & below data are for your ref only. For detailed info or customized requirements, you are very welcome to inquire.】

Model No.	Rated Voltage [V]	Open Speed [r/min]	Open Current [A]	Open Vacuum [mmH2O]	Seal Speed [R.P.M.]	Seal Current [A]
8224	AC 120V	31800	10.5	29	43300	6.7
Model No.	Seal Power [W]	19mm Orifice [RPM]	19mm Orifice [A]	19mm Orifice [Eff %]	19mm Orifice [W]	19mm Orifice [mmH2O]
8224	815	32885	9.8	38	1138	1647

Characteristic curve :

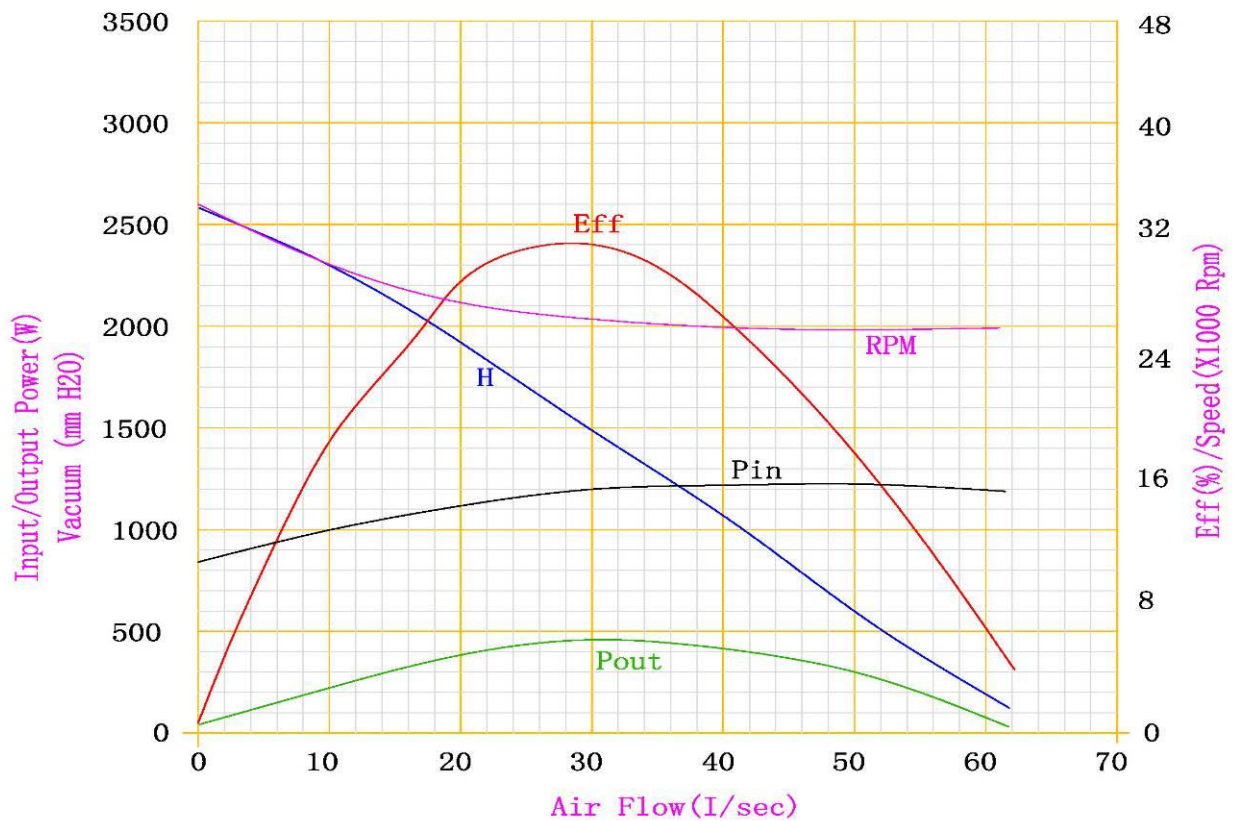

88 Universal Motor

Application

- Home Appliances
- Jumbo Blender/ Food Processor/ Meat Mincer

Motor Characteristics

- Diameter: 88mm
- Length: 157mm
- Shaft Diameter: 8mm
- Weight: 1820g
- Nominal Voltage: 120V~
- Frequency: 60Hz

Standard Data

- Operation Temperature: -10~55°C
- Storage Temperature: -20~100°C
- Mounting: Any Position
- Electrical Connection: Lead Wire
- Winding Temperature (Tmax): 130°C
- Direction of Rotation: CW

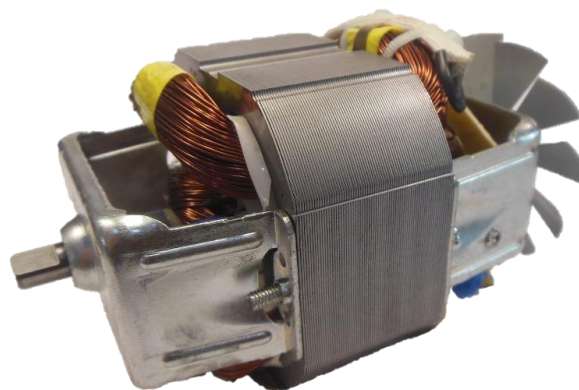

Dimensions

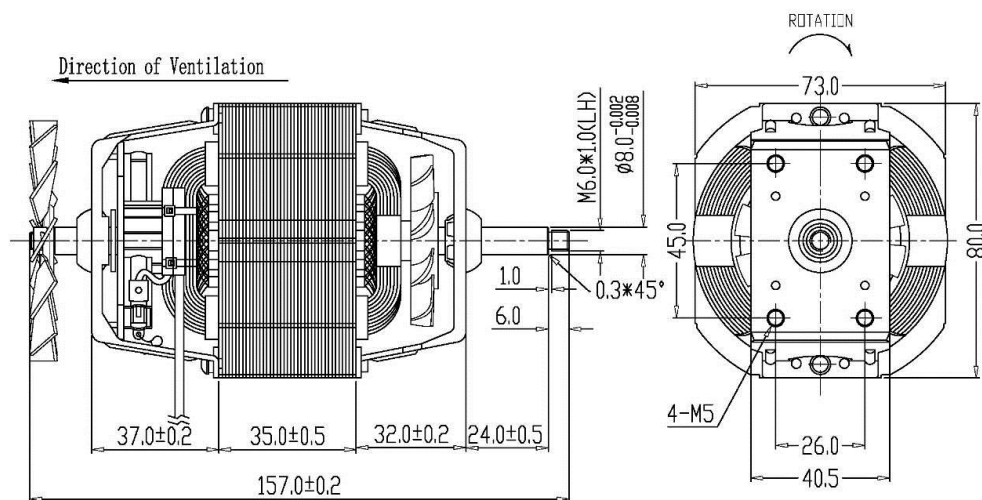

【Above dimensions & below data are for your ref only. For detailed info or customized requirements, you are very welcome to inquire.】

Model No.	Rated Voltage [V]	No-Load Speed [r/min]	No-Load Current [A]	Rated Torque [mNm]	Rated Speed [R.P.M.]	Rated Current [A]
8835	AC 120V	19600	2.18	400	9746	5.57
Model No.	In Pout [Watt]	Max-Efficiency [%]	Out-Pout [Watt]	Number of Pole/Pair	Dimensions [mm]	Weight [g]
8835	621	65	405	2	95	1820

Characteristic curve :

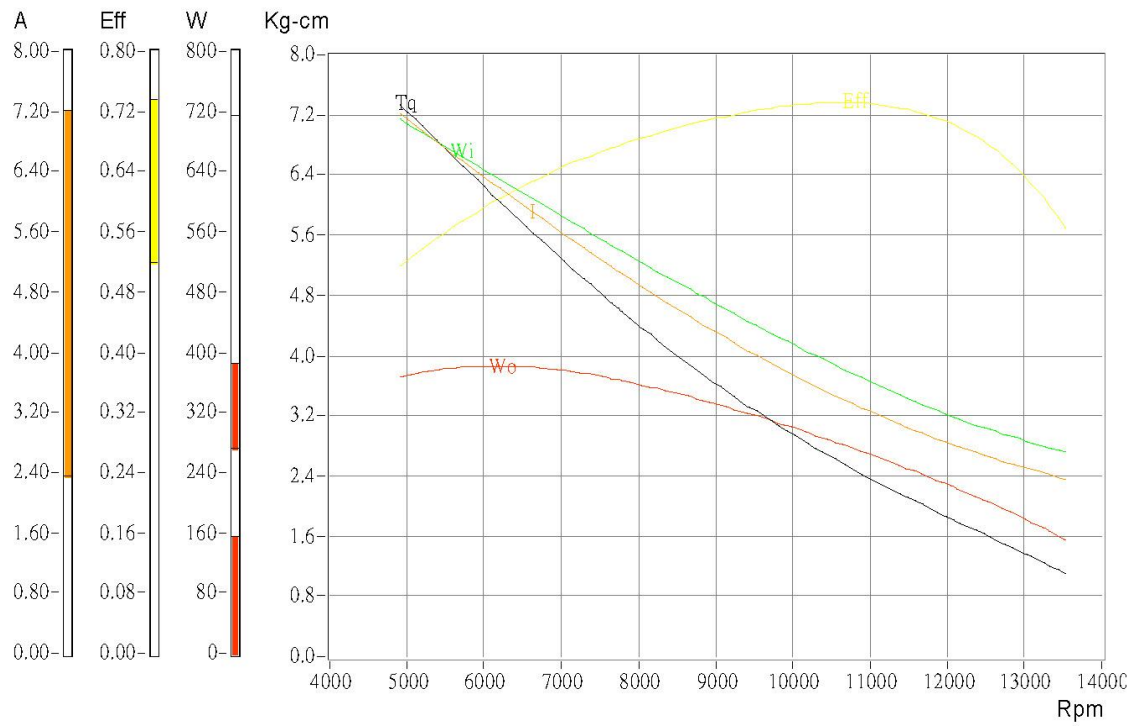

95 Universal Motor

Application

- Home Appliances
- Jumbo Blender/ Food Processor

Motor Characteristics

- Diameter: 95mm
- Length: 165mm
- Shaft Diameter: 8mm
- Weight: 1820g
- Nominal Voltage: 120V~
- Frequency: 60Hz

Standard Data

- Operation Temperature: -10~55°C
- Storage Temperature: -20~100°C
- Mounting: Any Position
- Electrical Connection: Terminal
- Winding Temperature (Tmax): 130°C
- Direction of Rotation: CCW

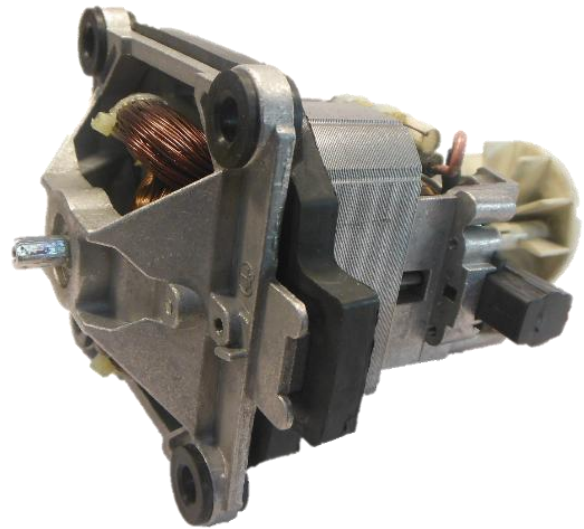

Dimensions

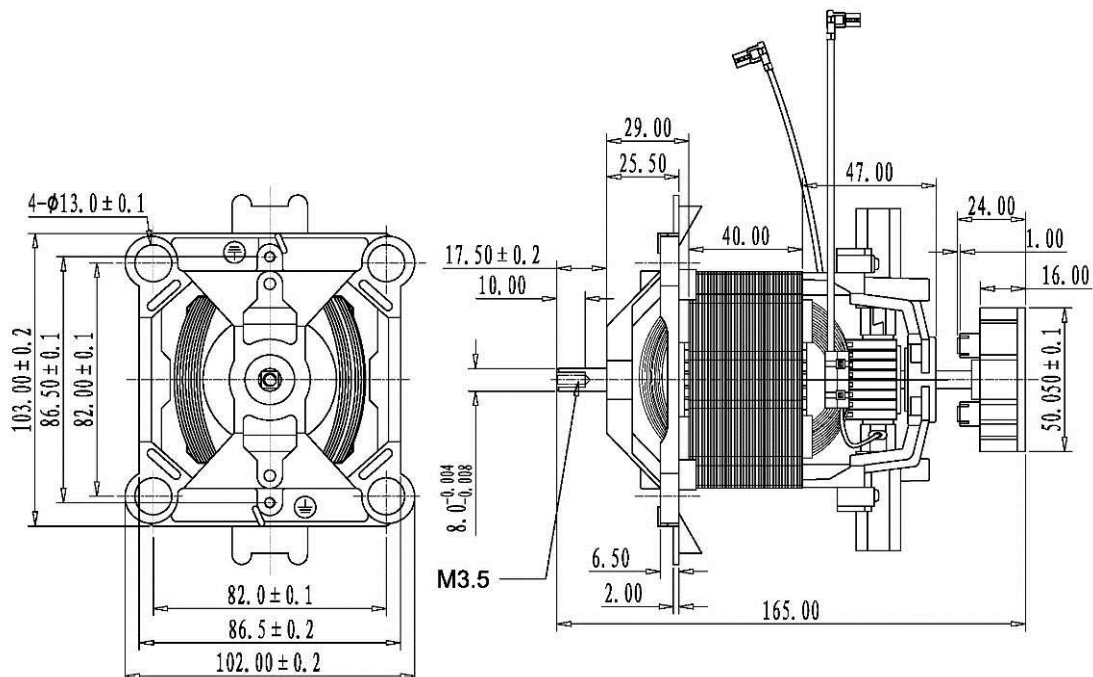

【Above dimensions & below data are for your ref only. For detailed info or customized requirements, you are very welcome to inquire.】

Model No.	Rated Voltage [V]	No-Load Speed [r/min]	No-Load Current [A]	Rated Torque [mNm]	Rated Speed [R.P.M.]	Rated Current [A]
9540	AC 120V	19600	2.18	400	9746	5.57
Model No.	In Pout [Watt]	Max-Efficiency [%]	Out-Pout [Watt]	Number of Pole/Pair	Dimensions [mm]	Weight [g]
9540	621	65	405	2	95	1820

Characteristic curve :

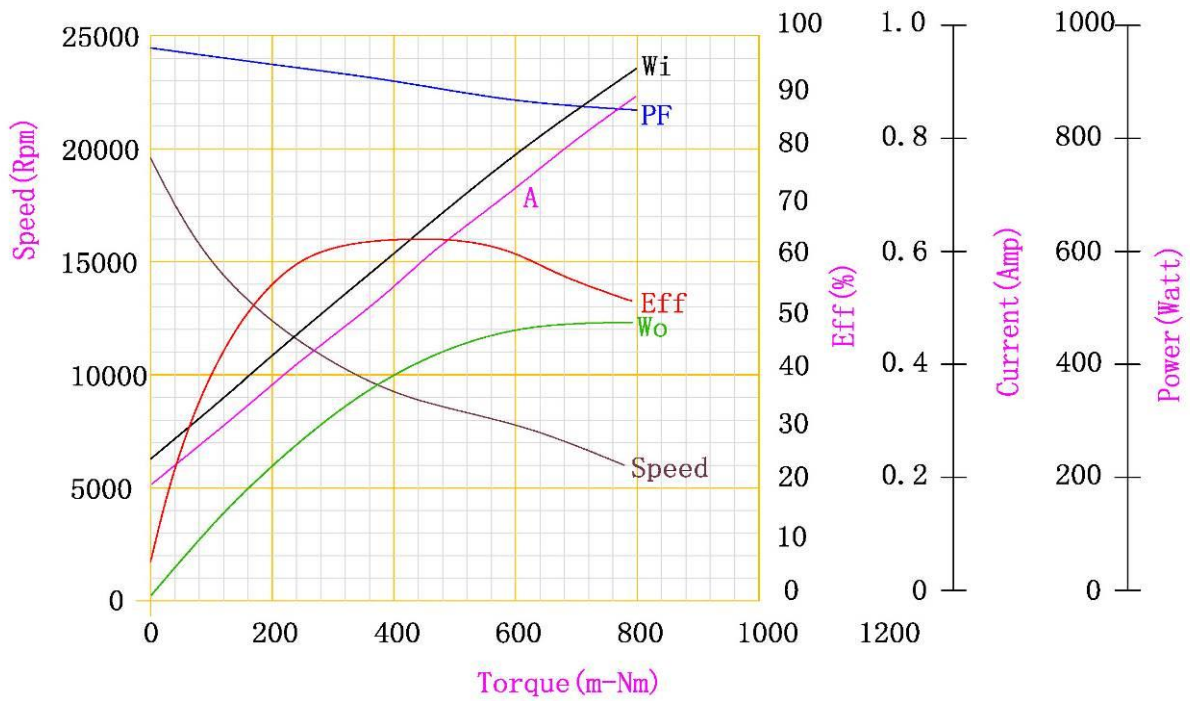

75 Induction Motor (Fan Motor)

Application

- Home Appliances
- Desk Fan

Motor Characteristics

- Diameter: W75mm
- Length: 154mm
- Shaft Diameter: 8mm
- Weight: 756g
- Nominal Voltage: 127V
- Frequency: 60Hz

Standard Data

- Operation Temperature: -10~55°C
- Storage Temperature: -20~100°C
- Mounting: Any Position
- Electrical Connection: Terminal
- Winding Temperature (Tmax): 130°C
- Direction of Rotation: CW

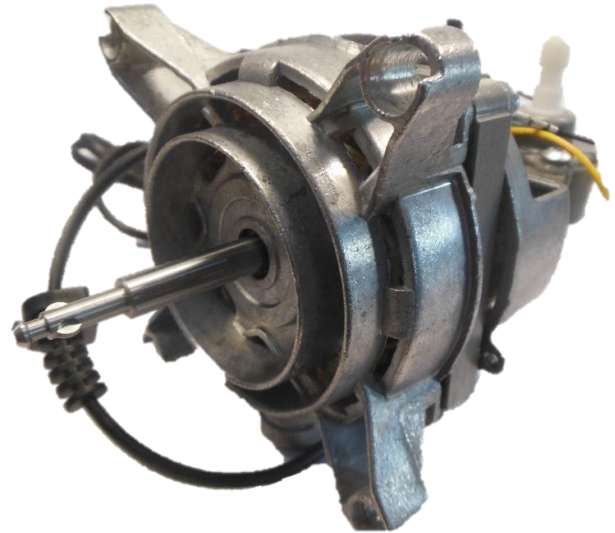

Dimensions

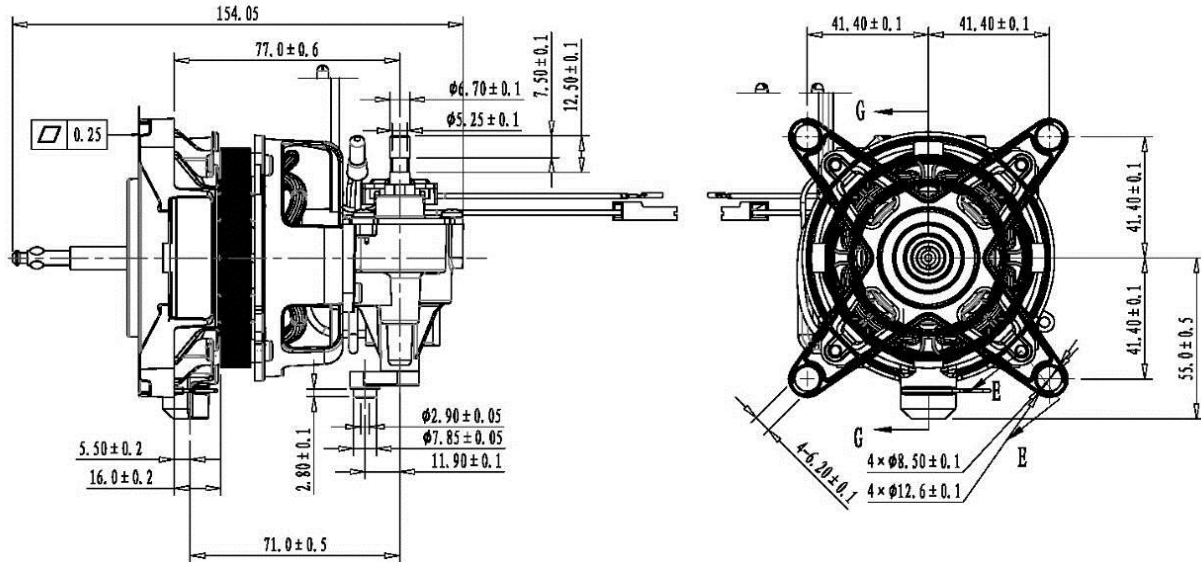

【Above dimensions & below data are for your ref only. For detailed info or customized requirements, you are very welcome to inquire.】

Model No.	Rated Voltage [V]	No-Load Speed [r/min]	No-Load Current [A]	Rated Torque [Kg-cm]	Rated Speed [R.P.M.]	Rated Current [A]
7510	AC 127V	1750	0.3	0.74	1350	0.38
Model No.	In-Pout [Watt]	Max-Efficiency [%]	Out-Pout [Watt]	Number of Pole/Pair	Dimensions [mm]	Weight [g]
7510	46.8	27	10.35	4	W75	756

Characteristic curve :

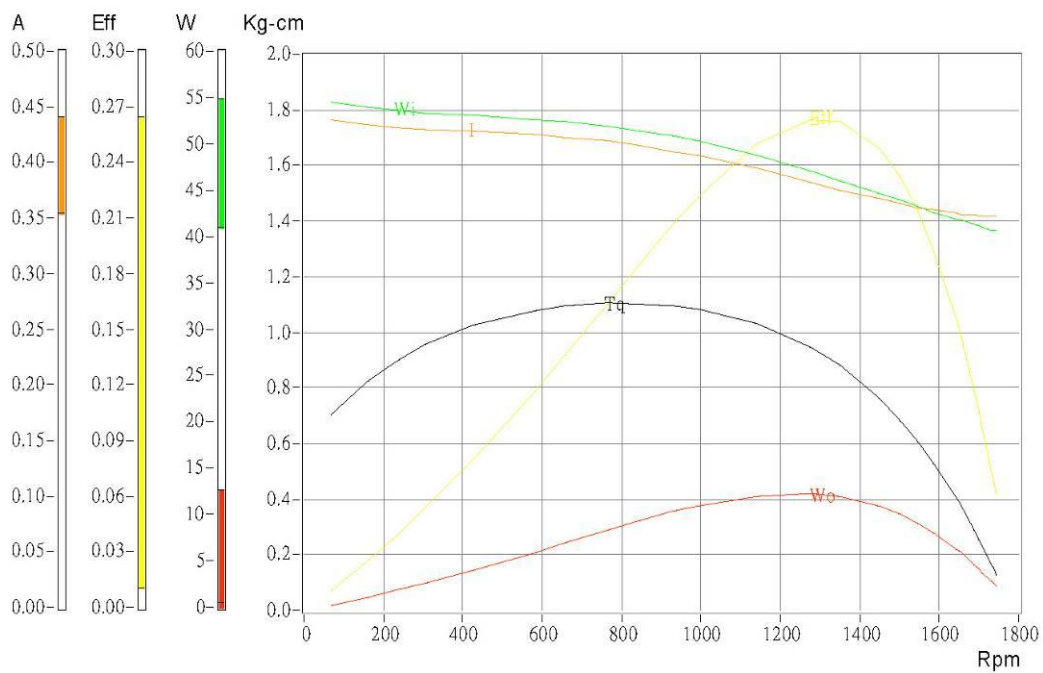

75 Induction Motor (Fan Motor)

Application

- Home Appliances
- Desk & Stand Fan

Motor Characteristics

- Diameter: W75mm
- Length: 221mm
- Shaft Diameter: 8mm
- Weight: 1725g
- Nominal Voltage: 127V~
- Frequency: 60Hz

Standard Data

- Operation Temperature: -10~55°C
- Storage Temperature: -20~100°C
- Mounting: Any Position
- Electrical Connection: Terminal
- Winding Temperature (Tmax): 130°C
- Direction of Rotation: CW

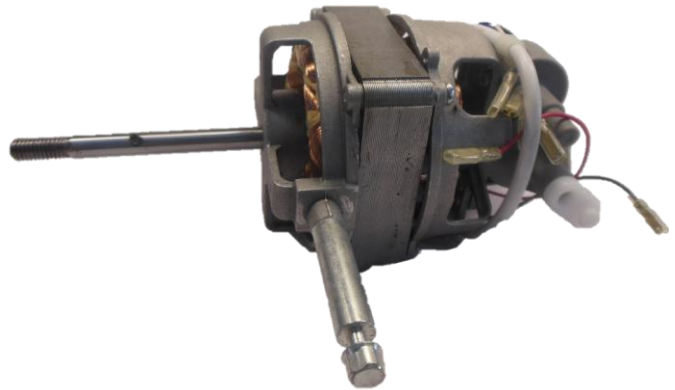

Dimensions

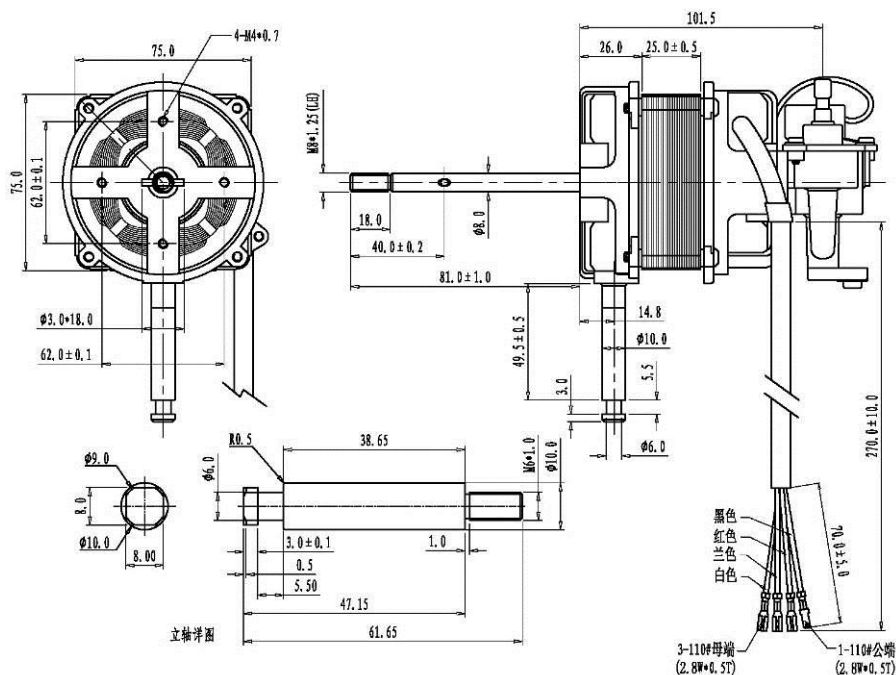

【Above dimensions & below data are for your ref only. For detailed info or customized requirements, you are very welcome to inquire.】

Model No.	Rated Voltage [V]	No-Load Speed [r/min]	No-Load Current [A]	Rated Torque [N.m]	Rated Speed [R.P.M.]	Rated Current [A]
7525	AC 127V	1750	0.7	0.17	1510	1.1
Model No.	In-Pout [Walt]	Max-Efficiency [%]	Out-Pout [Watt]	Number of Pole/Pair	Dimensions [mm]	Weight [g]
7525	126	35	45	4	W75	1725

Characteristic curve :

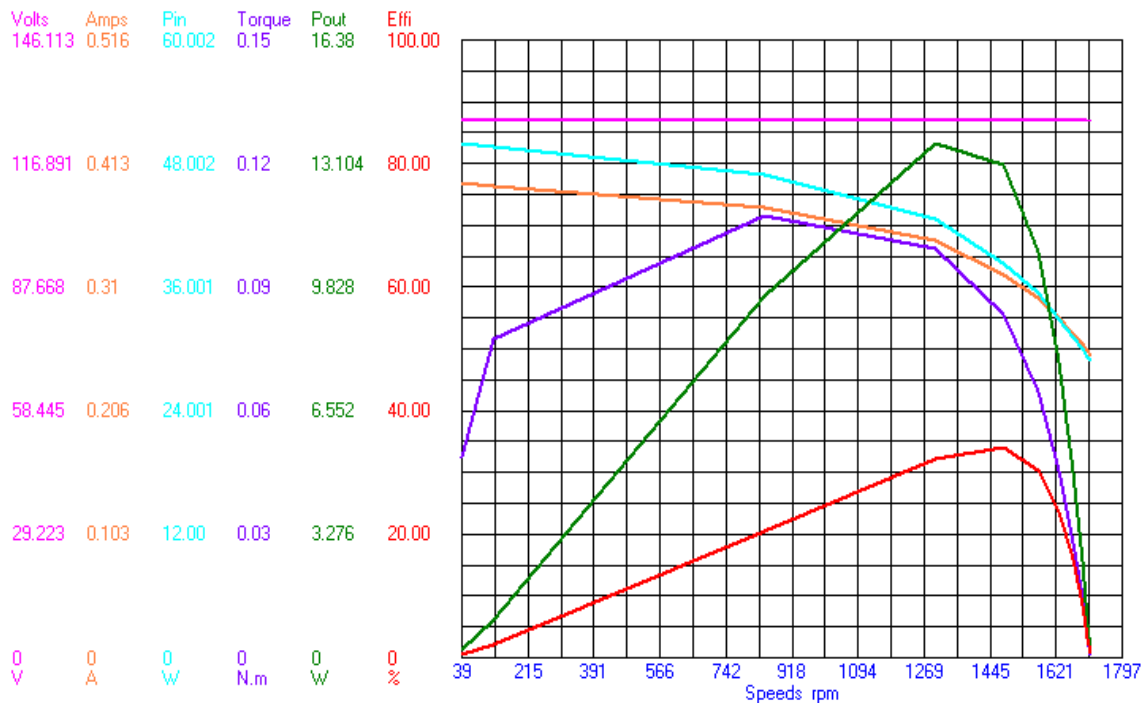

108 Induction Motor (Fan Motor)

Application

- Home Appliances
- Industrial Fan

Motor Characteristics

- Diameter: W108mm
- Length: 125mm
- Shaft Diameter: 8mm
- Weight: 1420g
- Nominal Voltage: 127V~
- Frequency: 60Hz

Standard Data

- Operation Temperature: -10~55°C
- Storage Temperature: -20~100°C
- Mounting: Any Position
- Electrical Connection: Lead Wire
- Winding Temperature (Tmax): 130°C
- Direction of Rotation: CW

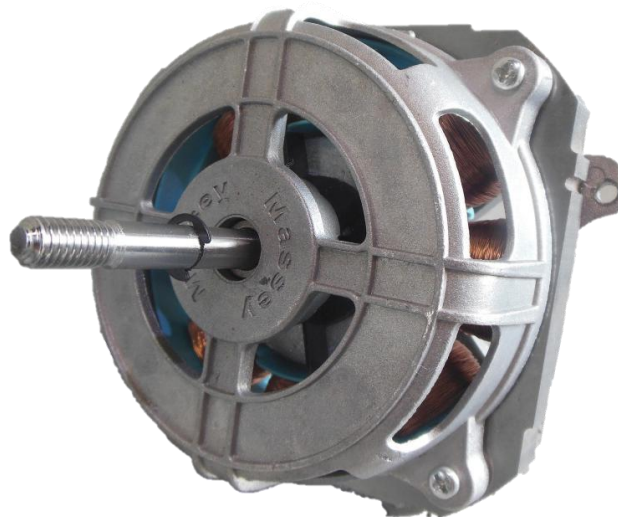

【Below data are for your ref only. For detailed info or customized requirements, you are very welcome to inquire.】

Model No.	Rated Voltage [V]	No-Load Speed [r/min]	No-Load Current [A]	Rated Torque [N.m]	Rated Speed [R.P.M.]	Rated Current [A]
10812	AC127V	1740	0.5	0.25	1250	0.8
Model No.	In-Pout [Watt]	Max-Efficiency [%]	Out-Pout [Watt]	Number of Pole/Pair	Dimensions [mm]	Weight [g]
10812	115	33	37	4	W108	1420

Characteristic curve :

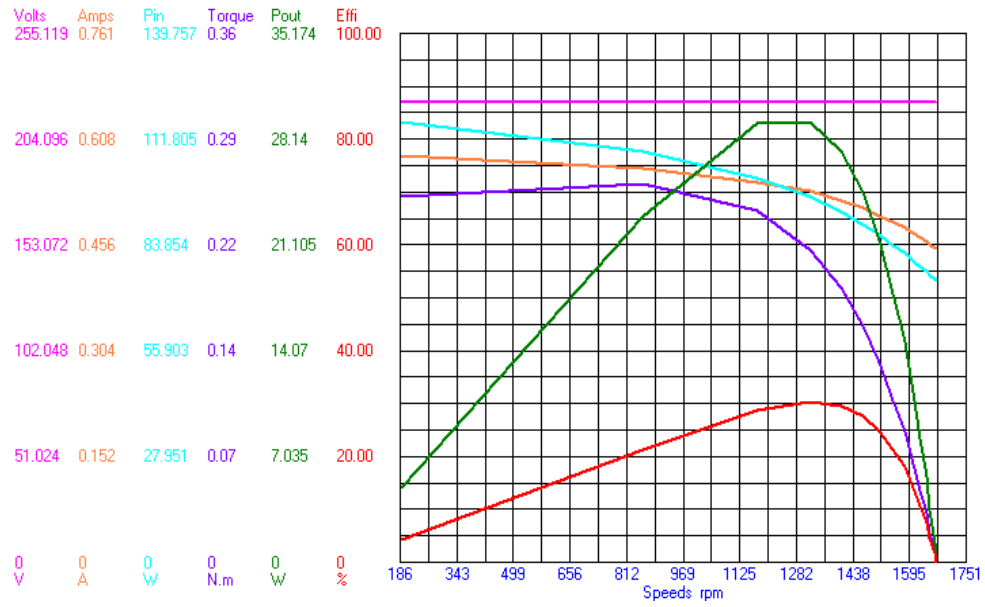

48 Shaded Pole Motor

Application

- Home Appliances
- Fan

Motor Characteristics

- Diameter: W48mm
- Length: 58.6mm
- Shaft Diameter: 4mm
- Weight: 298g
- Nomial Voltage: 110V~
- Frequency: 60Hz

Standard Data

- Operation Temperature: -10~55°C
- Storage Temperature: -20~100°C
- Mounting: Any Position
- Electrical Connection: Lead Wire
- Winding Temperature (Tmax): 130°C
- Direction of Rotation: CW

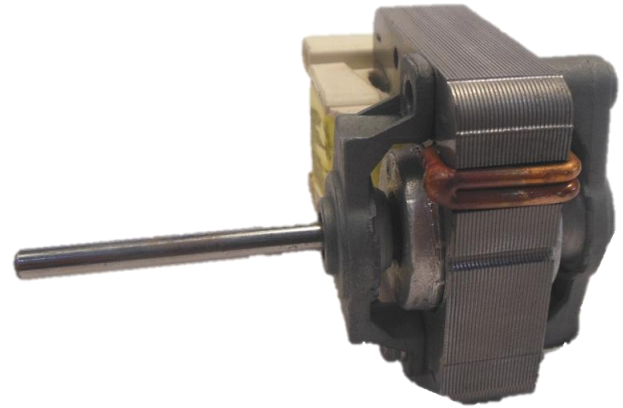

Dimensions

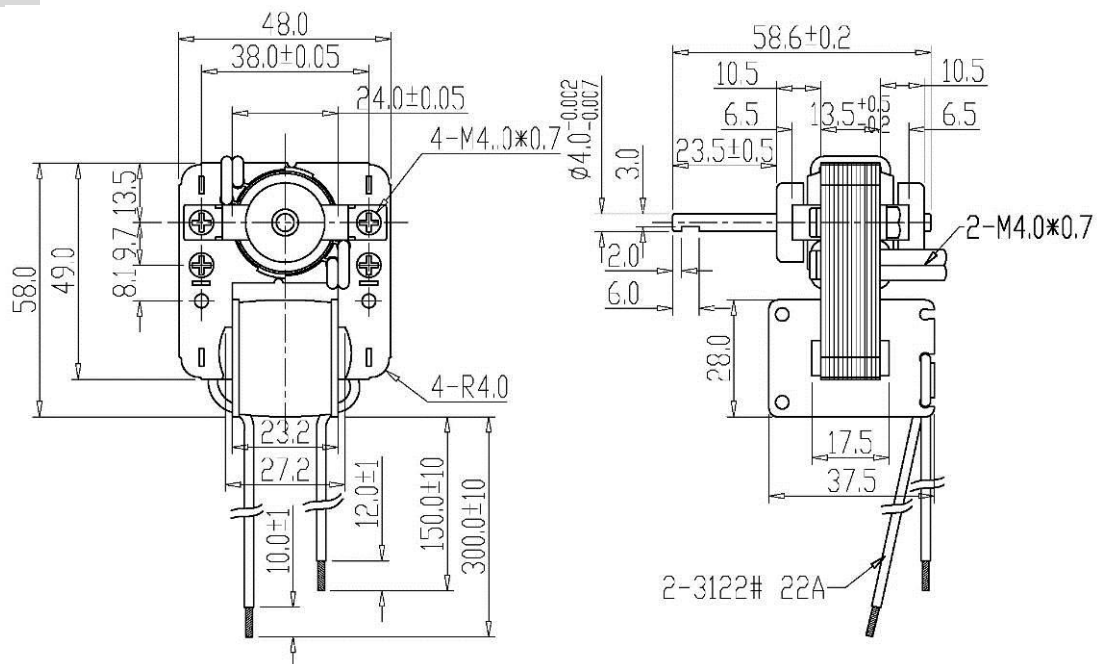

【Above dimensions & below data are for your ref only. For detailed info or customized requirements, you are very welcome to inquire.】

Model No.	Rated Voltage [V]	No-Load Speed [r/min]	No-Load Current [A]	Rated Torque [Kg-cm]	Rated Speed [R.P.M.]	Rated Current [A]
4814	AC 110V	2780	0.23	0.35	2000	0.4
Model No.	In-Pout [Watt]	Max-Efficiency [%]	Out-Pout [Watt]	Number of Pole/Pair	Dimensions [mm]	Weight [g]
4814	28	20	5	4	W48	298

Characteristic curve :

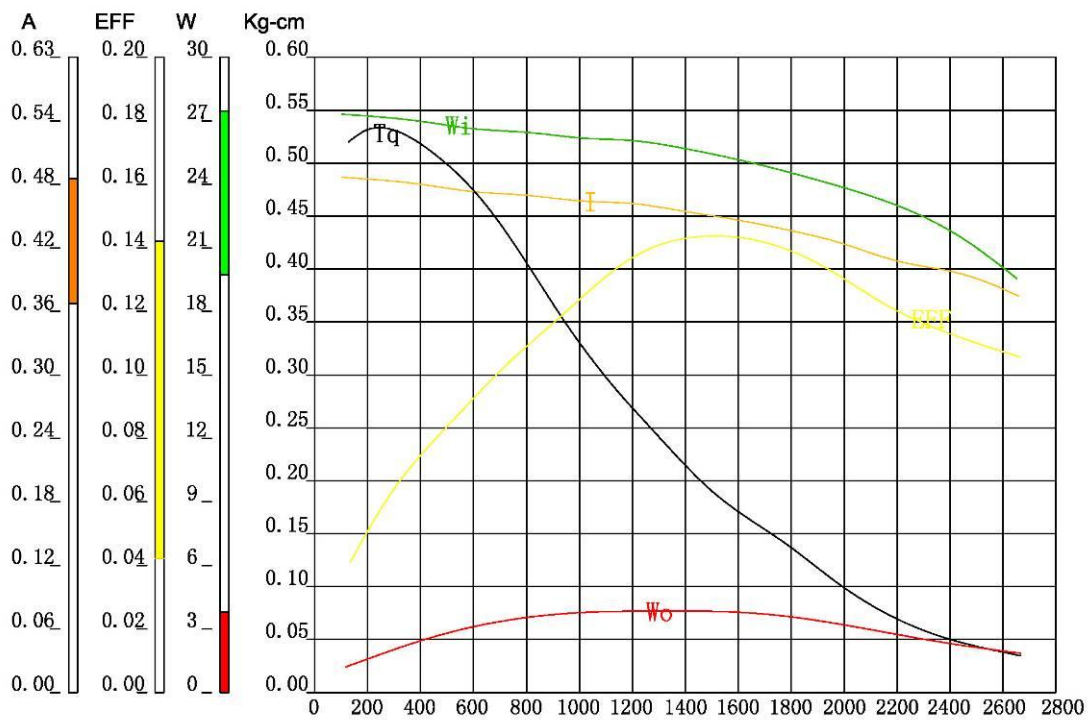

58 Shaded Pole Motor

Application

- Home Appliances
- Fan/ Juicer

Motor Characteristics

- Diameter: 58mm
- Length: 78.5mm
- Shaft Diameter :4mm
- Weight: 320g
- Nominal Voltage: 100V~
- Frequency: 50/60Hz

Standard Data

- Operation Temperature: -10~55°C
- Storage Temperature: -20~100°C
- Mounting: Any Position
- Electrical Connection: Lead Wire
- Winding Temperature (Tmax): 130°C
- Direction of Rotation: CW

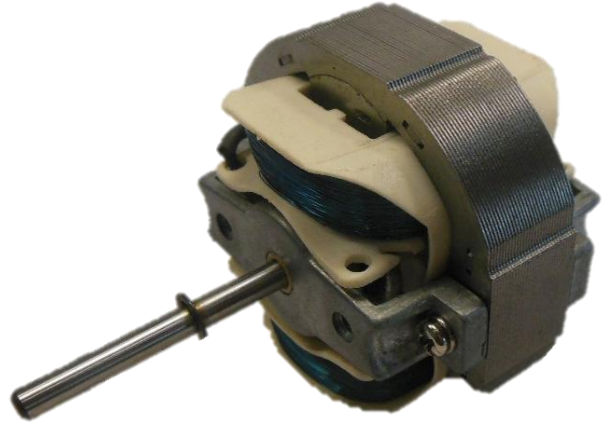

Dimensions

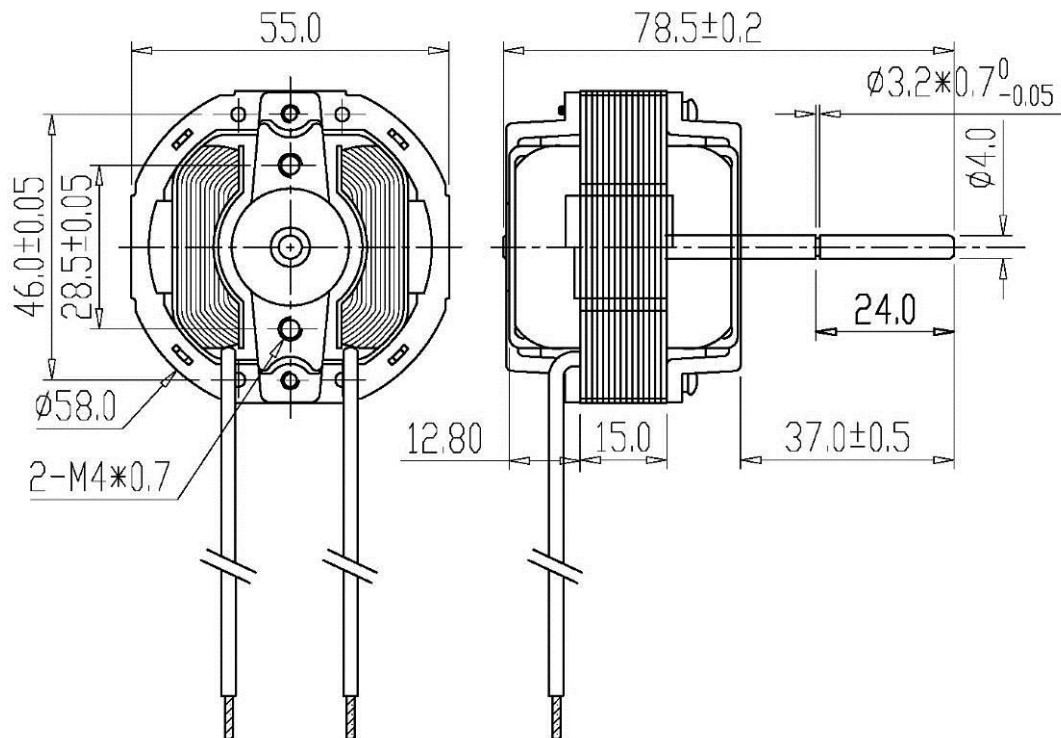

【Above dimensions & below data are for your ref only. For detailed info or customized requirements, you are very welcome to inquire.】

Model No.	Rated Voltage [V]	No-Load Speed [r/min]	No-Load Current [A]	Rated Torque [Kg-cm]	Rated Speed [R.P.M.]	Rated Current [A]
5815	AC 100V	2700	0.24	0.30	2100	0.35
Model No.	In-Pout [Watt]	Max-Efficiency [%]	Out-Pout [Watt]	Number of Pole/Pair	Dimensions [mm]	Weight [g]
5815	15	40	6	2	58	320

Characteristic curve :

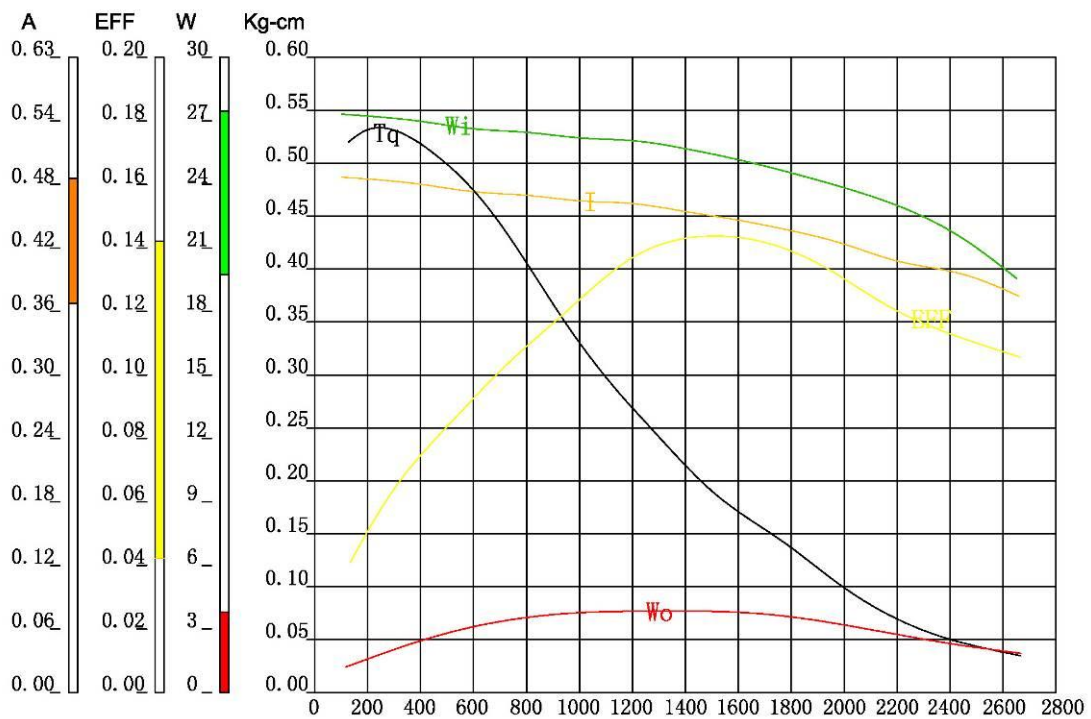

60 Shaded Pole Motor

Application

- Home Appliances
- Electrical Desk Fan

Motor Characteristics

- Diameter: W60mm
- Length: 127mm
- Shaft Diameter: 6mm
- Weight: 590g
- Nominal: 100V~
- Frequency: 50/60Hz

Standard Data

- Operation Temperature: -10~55°C
- Storage Temperature: -20~100°C
- Mounting: Any Position
- Electrical Connection: Lead Wire
- Winding Temperature (Tmax): 130°C
- Direction of Rotation: CW

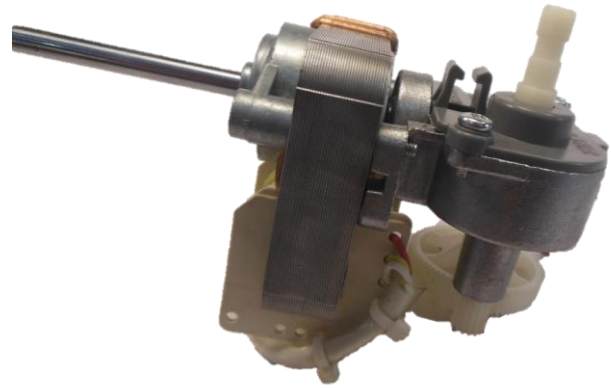

Dimensions

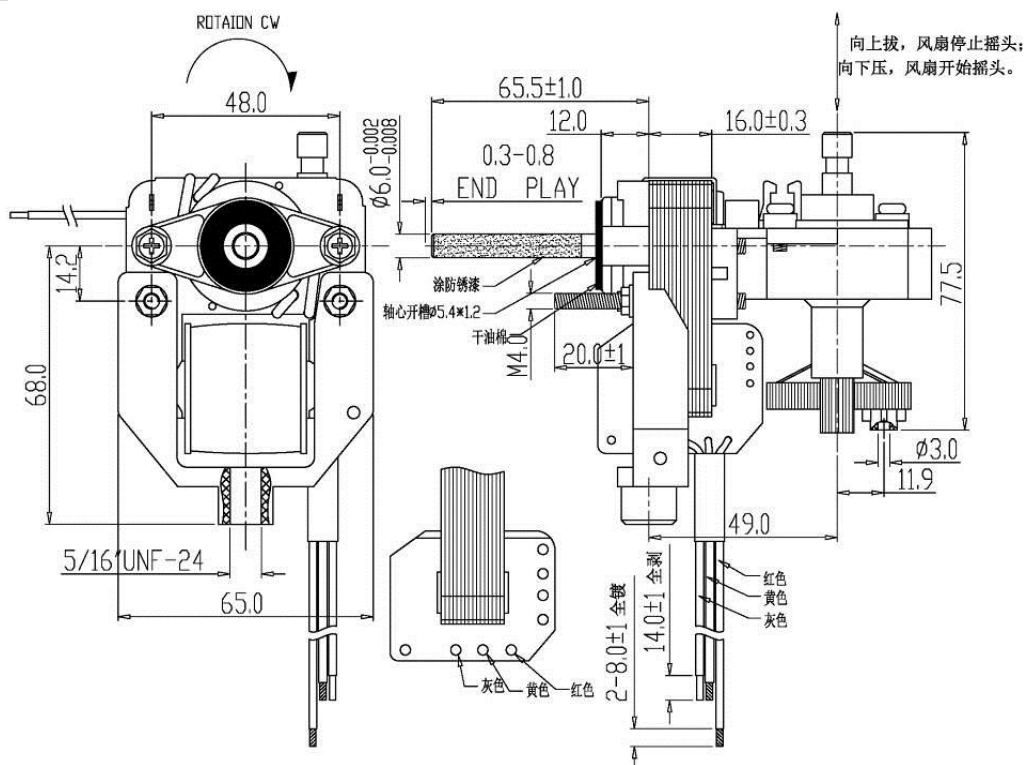

【Above dimensions & below data are for your ref only. For detailed info or customized requirements, you are very welcome to inquire.】

Model No.	Rated Voltage [V]	No-Load Speed [r/min]	No-Load Current [A]	Rated Torque [Kg-cm]	Rated Speed [R.P.M.]	Rated Current [A]
6016	AC 100V	2815	0.4	0.37	2350	0.45
Model No.	In-Pout [Watt]	Max-Efficiency [%]	Out-Pout [Watt]	Number of Pole/Pair	Dimensions [mm]	Weight [g]
6016	22	45	10	4	W60	590

Characteristic curve :

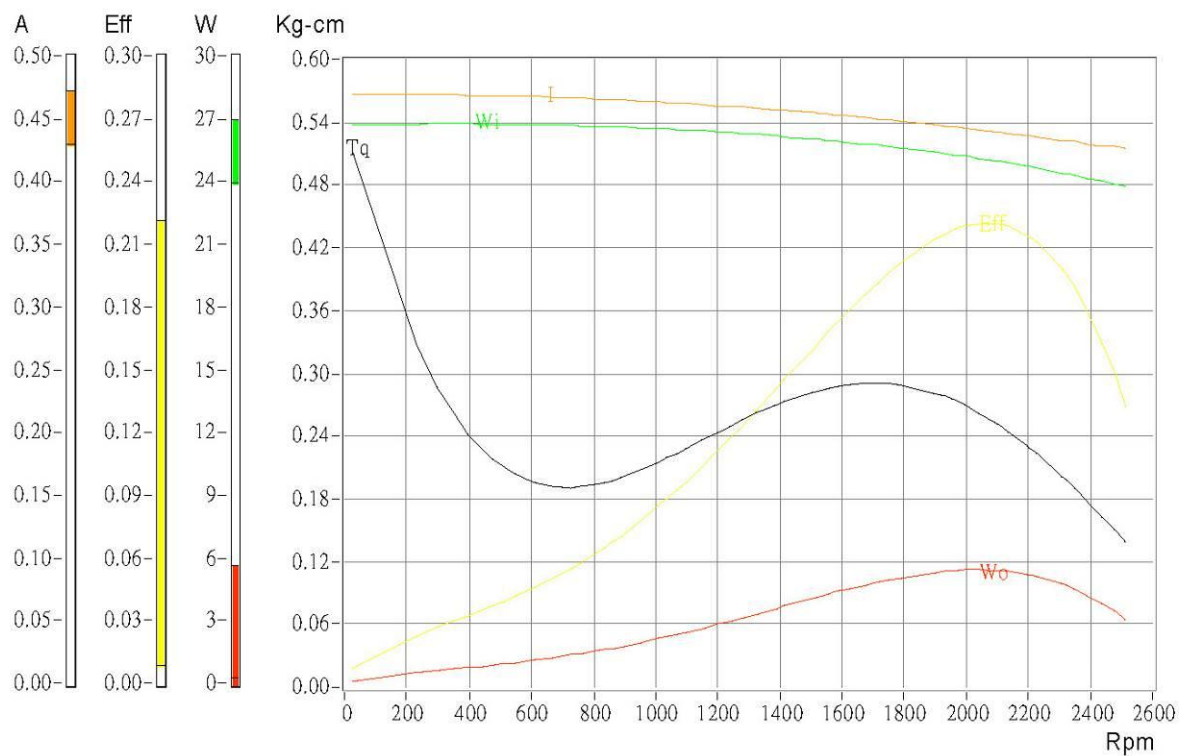

45 PMDC Motor

Application

- Home Appliances
- Coffee Maker With Grinder

Motor Characteristics

- Diameter: 45mm
- Length: 95mm
- Shaft Diameter: 5mm
- Weight: 350g
- Nominal Voltage: 230V~
- Frequency: 50/60Hz

Standard Data

- Operation Temperature: -10~55°C
- Storage Temperature: -20~100°C
- Mounting: Any Position
- Electrical Connection: Lead Wire
- Winding Temperature (Tmax): 130°C
- Direction of Rotation: CW



Dimensions

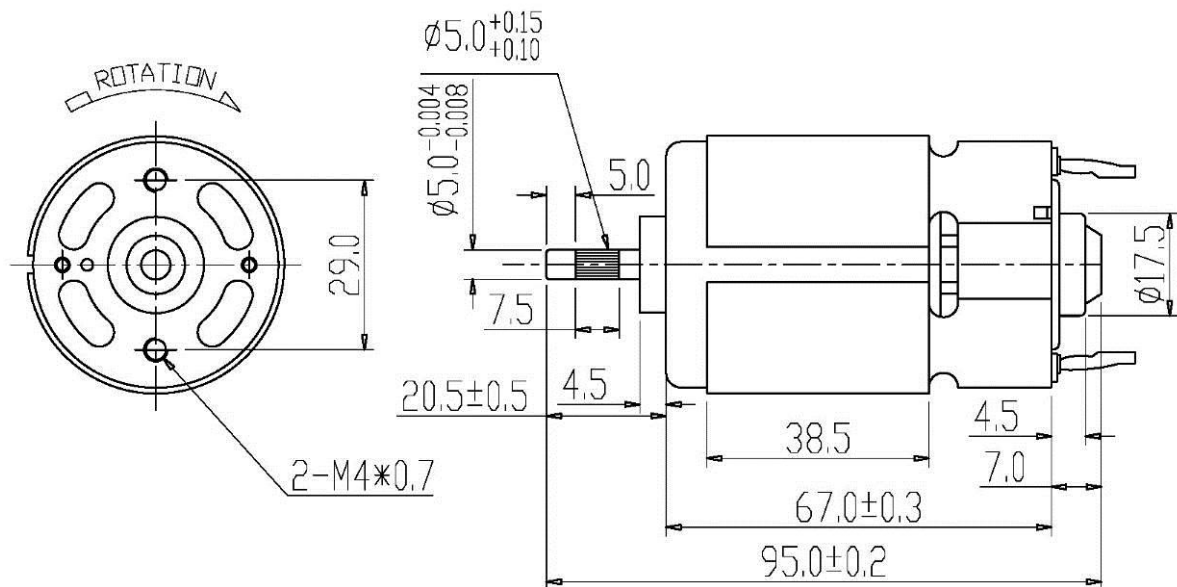

【Above dimensions & below data are for your ref only. For detailed info or customized requirements, you are very welcome to inquire.】

Model No.	Rated Voltage [V]	No-Load Speed [r/min]	No-Load Current [A]	Rated Torque [Kg-cm]	Rated Speed [R.P.M.]	Rated Current [A]
4525	AC230V	12720	0.12	0.3	10400	0.3
Model No.	Torque Constant [g-cm/A]	Max-Efficiency [%]	Out-Pout [Watt]	Number of Pole/Pair	Dimensions [mm]	Weight [g]
4525		52	32.2	2	45	350

Characteristic curve :

